

Sweeper

Name(s): _____

How can you combine pushing a cart with cleaning a path?
 Let's find out!



Build the Sweeper

(All of book 1A and book 1B to step 11.)

- Try it
- If it does not spin smoothly loosen the axle bushings and make sure the bricks are firmly linked to one another

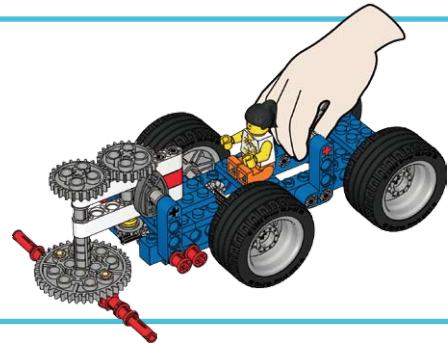

What makes a good Sweeper?

- Test your spin speeds with the gears shown below. Try them with only two sweeper blades (a).

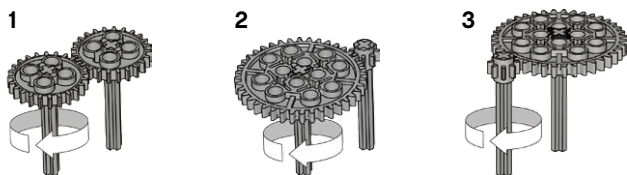

- Now try these sweeper blades with your FASTEST gears to see which one is best at sweeping crumbs

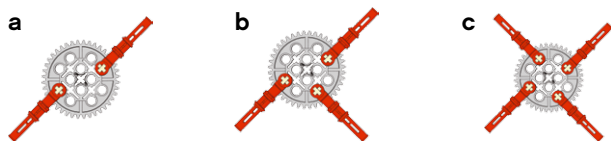

- Test different sweepers and compare them with your standard model

Tip: Write the words on the right into the boxes above. You can use them more than once. Make up your own descriptions too.

I tried this	My prediction	What happened?
1a		
2a		
3a		

The same Faster
 Slower
 Worse Better

A Safer Sweeper

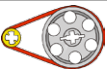
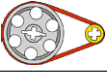
	Prediction	What happened?
		
		

My own discoveries:



Also try:

- Holding the sweeper blades while you push the sweeper
- Cleaning up crumbs from a carpet

My Amazing Table Sweeper

Draw and label your Sweeper design.
Explain how the three best parts work.